

Title.	Distance	Place	OS Map
<b>Aston Ponds</b>	0.6 Miles 1 Km	Aston Ponds Nr. Aston Nr. Wales	OS 111 Sheffield & Huddersfield

Aston Park Fisheries is predominately for fishing – but has a Restaurant & Farm Shop and a family Farm Trail [ but it is unsuitable for wheelchairs ]. It is one of the finest modern day fisheries in the area and close to all major links of the M1, A1 and M18, yet it is a haven for pleasure and club anglers.

There are five lakes, which have large stocks of fish, including various Carp to 30lb plus, Tench, Bream, Roach, Perch, Barbel and Crucians. Pleasure fishing is available 7 days per week with an onsite tackle shop, and Bait Bar.

Aston Springs Farm is also a great family day out and there is a pet's area to view with chickens, goats, ducks and also a farm trail in which children must be accompanied by an adult there is a charge for the walk and tickets can be obtained from the Farm Shop.

On the Trail there are various paddocks, and you can see sheep & lambs, free-range chickens, pigs, goats, red deer, donkeys and highland cattle.

The Farm Trail has steep inclines and is not suitable for wheelchair users or buggies.

See the Aston Ponds website - [www.astonparkfisheries.co.uk](http://www.astonparkfisheries.co.uk)

- **Facilities** – 5 fishing lakes – Waters Edge Café & Bait Bar – Aston Farm Restaurant & The Farm Shop selling local produce – Pets Area – Family Farm Trail.

There are 3 car parks 1 at the main entrance – 1 outside the Farm Shop – and 1 near the Waters Edge Cafe

- **Café** – Near the entrance is the Aston Restaurant selling a variety of refreshments and open daily from 10 am. to 4 pm. there is also the Waters Edge Café with refreshments further down the road lane.



Farm Shop & Café

- **Toilets** – There are well-equipped toilets and disabled toilets at both cafés.
- **Path** – The lakes are for fishermen, but you can watch them in action, and respect the quietness of fishing.

From the Farm Shop is a gravel path where you can view the lakes and this leads to the lane which is made up of a concrete surface which has some pot holes - it is suitable for motorised wheelchairs, but manual wheelchairs / pushchairs will need a pusher. It is a forward and back walk



Concrete Lane Surface

- **Information** – There is information on the website

Tel. No. – Fishing Match bookings - 07743 845737

- **Website** –

<https://www.astonspringsfarm.co.uk/>

<http://www.astonparkfisheries.co.uk/>

- **Directions** – Aston Ponds is near Rotherham / Sheffield and close to the M1 junction 31 turn on the A57 towards Sheffield and then left on the A618 and the Aston Ponds entrance is on the left hand side.
- **Places to visit nearby** – Rother Valley Country Park – Ulley Country Park – Kiveton Country Park



Farm Building



Aston Ponds



Lane



Fisherman's Ponds



Fisherman

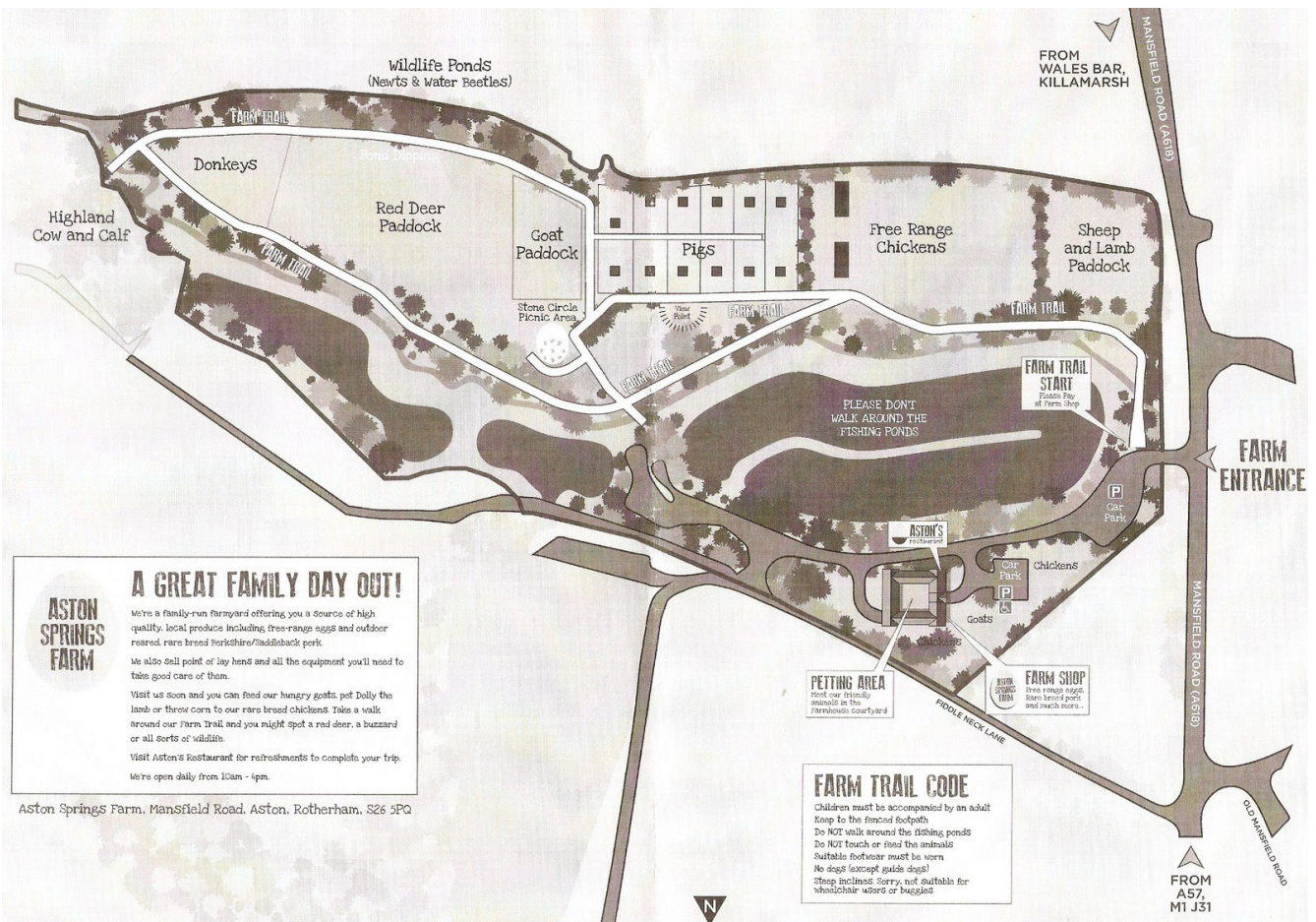

Family Farm Trail Map [ Note:- Not for wheelchairs ]